



# **Year 7 Enrolment Information Handbook 2024**

# INTRODUCTIONS

---

## HEAD OF MIDDLE SCHOOL - Justin Bond

Welcome to East Doncaster Secondary College. We value and celebrate the pursuit of excellence. Our focus is student connectedness and student learning. We establish agreed expectations that are strongly infused with respect, trust and collaboration.



During this exciting time of transition from primary to secondary education, we will do our best to support students. It is our intention that all students and their families share in the rich culture of our school and be as proud of being at East Doncaster Secondary College as we are. We want our students to be the best they can be.

This information booklet contains key information about our College, contacts, important dates and the program for Orientation Day.

Parents and students are cordially invited to attend our planned Information Evening at 7.00pm, Monday 20 November 2023 in the East Doncaster Secondary College Sports Centre (entrance via Carpark C on Dryden Street). Orientation Day is held on Tuesday 12 December 2023 from 8.45am until 3.15pm.

Student placement into Home Groups for 2024 will be based on information we receive from primary schools and other considerations.

You will be notified prior to Orientation Day as to which Home Group, House, Positive Futures pastoral group and Languages (Language Other Than English) your child has been allocated.

If you have any queries regarding the Information Pack, the Information Evening, or other matters, you are welcome to contact us on 9842 2244.

## TRANSITION COORDINATOR - Tina Marchant

A message to all new Year 7 students from the Transition Coordinator

Welcome and congratulations on your successful placement at East Doncaster Secondary College – your new school home and where you will be spending a lot of time over the next six years. Our Year 7 team have already been working behind the scenes to prepare a learning environment in which you will grow academically and thrive personally.



Over the next few months we will be gathering a lot of information about you and how you learn best and are getting ready for you to take your place in your new home group. Whether you love to learn or sometimes struggle a bit – we are there to support you. Perhaps you are curious about new subjects or activities you can get involved in. Think about trying out for a sport team or learning an instrument, joining a club or helping out in the library.

New experiences can be exciting and sometimes a bit scary! There will be so many new people to meet – students, teachers and other school staff. Get ready to be a great friend who is accepting and kind as well as a great learner who is open to new ideas and willing to try hard. Practice getting school tasks finished on time and get organised with your books and materials. You could even buy a lock and practice opening and closing it in readiness for using your very own locker.

I am looking forward to meeting you in person.

See you on Orientation Day if not before.

# COLLEGE CONTACTS

---

<b>Address</b>	<b>Telephone</b>	03 9842 2244
20 George Street Doncaster East Victoria 3109	<b>Website</b>	<a href="http://www.eastdonsc.vic.edu.au">www.eastdonsc.vic.edu.au</a>
	<b>E-mail</b>	<a href="mailto:east.doncaster.sc@education.vic.gov.au">east.doncaster.sc@education.vic.gov.au</a>

## Staff Contacts:

<b>Principal</b>	John Roberts
<b>Assistant Principals</b>	Karen Boyle, Cameron Campbell, Jasvinder Kaur
<b>Head of Middle School</b>	Justin Bond
<b>Transition Coordinator</b>	Tina Marchant

# IMPORTANT DATES

---

DATE	EVENT
<b>End of November 2023</b>	Parents notified of Home Group, House, Positive Futures Group and Language Other Than English subject (LOTE) information
<b>Monday 20 November 2023 – 7.00pm</b>	Information Evening in EDSC Sports Stadium
<b>Tuesday 12 December 2023 – 8.45am until 3.15pm</b>	Year 7 2024 Orientation Day
<b>Tuesday 30 January 2024</b>	First day of Term 1 – All Year 7 students attend
<b>Friday 2 February 2024</b>	School Photos 2024
<b>Monday 26 February to Wednesday 28 February 2024</b>	Group 1 attends Year 7 Camp
<b>Wednesday 28 February to Friday 1 March 2024</b>	Group 2 attends Year 7 Camp

# ORIENTATION DAY

---

<b>When?</b>	<b>Tuesday 12 December 2023</b>
<b>What time should I get to EDSC?</b>	8.40am – The first bell rings at 8.45am
<b>Where do we meet?</b>	Go to the Middle Courtyard. Stand in front of the sign for your Home Group.
<b>What should I wear?</b>	Comfortable clothes and runners. You do not have to wear your primary school uniform.
<b>What should I bring?</b>	A hat, pencil case, lunch, drink. <i>Optional</i> – money for the canteen. Please do not bring valuable items. Bring everything in a small bag.
<b>What should I do if I am late?</b>	Call the office on 9842 2244 to let them know. Someone will pick you up from the office and take you to your class.
<b>What are the Home Groups called?</b>	The classes are alphabetical i.e. 7A, 7B, 7C etc.
<b>What time does the day finish?</b>	3.15pm Students will be dismissed from the Middle Courtyard. Please organise a suitable meeting place with your student after school.

# BELL TIMES

---

Monday, Wednesday, Thursday & Friday	
SESSIONS	TIMES
Locker bell	8.45 am
Period 1	8.55 am - 9.45 am
Period 2	9.45 am -10.35 am
Recess	10.35 am -11.00 am
Locker Bell	10.50 am
Period 3	11.00 am -11.50 am
Period 4	11.50 am - 12.40 pm
Lunch	12.40 pm -1.35 pm
Locker Bell	1.25 pm
Period 5	1.35 pm - 2.25 pm
Period 6	2.25 pm – 3.15 pm
End of Day	3.15 pm

Tuesdays	
SESSIONS	TIMES
Locker bell	8.45 am
Period 1	8.55 am – 9.37 am
Period 2	9.37 am – 10.19 am
Recess	10.19 am – 10.44 am
Locker Bell	10.34 am
Positive Futures	10.44 am – 11.32 am
Period 3	11.32 am – 12.14 pm
Period 4	12.14 pm – 12.56 pm
Lunch	12.56 pm – 1.51 pm
Locker Bell	1.41 pm
Period 5	1.51 pm – 2.33 pm
Period 6	2.33 pm – 3.15 pm
End of Day	3.15 pm

# TERM DATES 2024

---

Term 1	30 January - 28 March
Term 2	15 April - 28 June
Term 3	15 July - 20 September
Term 4	7 October - 20 December

# YEAR 7 SUBJECTS

## Year length subjects

- English OR English as Additional Language (EAL)
- Mathematics
- Science
- Humanities
- Music
- Languages - Italian OR Chinese
- Humanities
- Health and Personal Development (HPD)
- Physical Education (PE)
- Sport
- Positive Futures

## Semester length subjects

- Food Technology
- Wood Technology
- Music
- Drama
- Art
- Visual Communication

## EXAMPLE OF A YEAR 7 TIMETABLE

Student:

Active

Dashboard	Schedule	Personal	Billing	Learning Tasks	Attendance	Reports	Analytics	Insights
Today		Jump to: 06/08/2023		Go		Week		Month
Aug 6, 2023		Mon 7	Tue 8	Wed 9	Thu 10	Fri 11	Sat 12	
8:00: 2023 Courtyard Tales - College Magazine Pre-order - BUL		Cycle 4 Learning task ... Student learning goal				C4 LT1 - Active Listen... Yr 7 English Cycle 4 L...		
8am								
9am	8:55: 1 - 7PEE - ST3 -	8:55: 1 - 7DTE - R305 -	8:55: 1 - 7HUE - R519 -	8:55: 1 - 7HPDE - R204 -	8:55: 1 - 7SCE - R306 -			
10am	9:45: 2 - 7PEE - ST3 -	9:37: 2 - 7DTE - R305 -	9:45: 2 - 7HUE - R519 -	9:45: 2 - 7ENE - R509 -	9:45: 2 - 7MUE - R602 -			
11am	11:00: 3 - 7ENE - R525 -	10:44: PF - POSF63 - R528 -	11:00: 3 - 7MAE - R534 -	11:00: 3 - 7MAE - R536 -	11:00: 3 - 7MAE - R405 -			
12pm	11:50: 4 - 7MUE - R602 -	11:33: 3 - 7ENE - R524 -	11:50: 4 - 7IL3 - R522 -	11:50: 4 - 7MAE - R536 -	11:50: 4 - 7ENE - R509 -			
1pm		12:14: 4 - 7ENE - R524 -						
		1:00: Year 7 Girls Basketball - Division - ST12 - PAM						
2pm	1:35: 5 - 7VCE - R205 -	1:51: 5 - 7SP5 - ST5 -	1:35: 5 - 7ENE - R534 -	1:35: 5 - 7HPDE - R537 -	1:35: 5 - 7HUE - R407 -			
3pm	2:25: 6 - 7VCE - R205 -	2:33: 6 - 7SP5 - ST5 -	2:25: 6 - 7SCE - R306 -	2:25: 6 - 7IL3 - R509 -	2:25: 6 - 7IL3 - R535 -			
4pm								
5pm								

# POSITIVE FUTURES

---

Students meet weekly on Tuesdays in house and year level-based classes for Positive Futures. Positive Futures sessions aim to enhance student wellbeing, increase connectedness, and equip students for life as global citizens. We focus on developing authentic relationships within our school community and strive to embed the concept of teaching the “whole child”.

Positive Futures bring together a whole school approach to Positive Education with a focus on: positive health, positive self, positive relationships, accomplishment, positive emotion, meaning and positive engagement.

Topics include: resilience, self-care, Community action, goal setting, communication, Peer Support Mento Program, leadership, careers, study skills, mindfulness, gratitude and celebrating national days.

## HOUSE SYSTEM

---

Students are allocated to one of four Houses for Intra-school sporting activities. The houses are named after famous Australians – Bradman (Blue), Chisholm (Gold), Dunlop (Green) and Sutherland (Red).

School pride that supports a strong sense of belonging is enhanced through our vibrant House system. Our sporting carnivals in Swimming, Athletics and Cross Country are wonderful examples of our community striving to be their best and further developing teacher and student relationships.

## ALPHA

---

ALPHA (Advance Learning Program for High Achievers) caters for high potential learners across all curriculum areas. Typically, our ALPHA students show advanced academic development, a capacity for a fast pace of learning and a higher level of achievement. It enables like-minded and highly motivated students to be stimulated in a challenging and supportive learning environment.

ALPHA is offered to Year 6 students transitioning to Year 7 only. Students will then be enrolled in ALPHA for Year 7, 8 & 9.

To be considered for the ALPHA in Year 2024, students must apply for and be offered an enrolment at East Doncaster Secondary College.

Students who have been offered an enrolment for Year 7 are invited to undertake a rigorous selection process during Grade 6 with testing in numeracy, literacy, writing, logic and reasoning. This is complemented by the provision of a student profile, developed with the cooperation of the student’s primary school teacher.

It is our specific intention that ALPHA students should strive for educational excellence and develop high levels of creativity along with an extended capacity for complex problem solving. Importantly we also help them to develop their interpersonal skills of resilience, leadership, empathy and perseverance. We support them to continue as highly engaged and motivated students so that the foundations are there for outstanding performance in VCE. Acceleration in the study of Mathematics enables many of our ALPHA students to begin their VCE Mathematics plus a further VCE study of their choice in Year 10.

ALPHA classes are supplemented by opportunities for students to become involved in other programs that enable them to develop their gifts, thereby enriching and balancing their learning. Such opportunities exist in sports teams, drama, the Music Program, debating, student leadership and assisting in the organisation of ALPHA events.

The ALPHA test for 2024 took place on 9 September 2023.

# YEAR 7 ANGLESEA CAMP

Educational Purpose of the Program:	Challenge and team building camp to assist transition from Primary to Secondary school
Details of Supervising Staff:	Staff : Student ratio 1:10
Distance from Expert Medical Care:	Anglesea Medical Centre – 170 metres
Accommodation Arrangements:	YMCA Anglesea Recreation Camp
Travel Arrangements:	Bus Company
Activities that may be offered to Students throughout the program:	Surfing, canoeing, raft building, high ropes, giant swing, vertical challenge, mountain biking, skateboarding, rogaining, initiatives. A Risk Management Plan for this program has been developed by staff and is available to parents to review upon request.
Permission/Medical Consent Forms:	A link will be provided to you through your Compass Email in Week 1, Term 1 of 2024.
Confirmation of cost, payment date, Camp Groups and their departure dates will be communicated in Week 1, Term 1 of 2024.	

The annual Year 7 Anglesea Camp is a very important component of the Transition program at Year 7. It provides students with the opportunity to mix socially with their new classmates and to participate in a range of outdoor educational activities. It also provides staff an opportunity to build relationships with students. All students are expected to attend.

The YMCA Anglesea Recreation Camp is 110 kilometres from Melbourne. It is situated off the main highway on the Geelong side of Anglesea. The camp is on 10 hectares of bushland and is within easy walking distance of Anglesea Surf Beach, river and township.

Year 7 Camp runs for three days. The year level is split into two, with half attending from Monday to Wednesday and the remainder from Wednesday to Friday. In this week students attend the normal school program on the two days they are not on camp.

Parents are responsible for all medical costs if a student is injured on a school approved excursion unless the Department of Education and Training is found liable (liability is not automatic). Parents can purchase student accident insurance cover from a commercial insurer if they wish. The College advises insurance or ambulance subscription particularly for the adventure-based activities undertaken during the camps program.

For further information you may contact Justin Bond, Head of Middle School, on 9842 2244.



# BOOKLIST ONLINE

---

In 2024 we will continue with our whole school 1 to 1 Digital Learning Program for all students. Our Year 7 students will be requested to purchase a laptop. The use of these devices is crucial to the learning program as students will access eBooks rather than an extensive number of expensive textbooks. Details of the 1 to 1 Digital Learning Program for all students are available on Compass. (Please note that laptops and eBooks are not included in Parent Payments).

There will be a limited number of books, novels and stationery required to be purchased for 2024. Please note: Do not place your booklist order until you have received confirmation of your child's Languages subject.

To purchase these items, follow the instructions below:

- The Year 7 2024 online booklist will be available from 13/10/2023. It is best to place orders before 14/12/2023.
- To order your school books online, please visit [www.campion.com.au](http://www.campion.com.au)
- Click 'Order Here' and create an account
- Select *East Doncaster Secondary College* from the drop down list in 'VICTORIA' Schools.
- Enter the Code **XTB4** this will give you the list of resources by year levels.
- Select resources needed and follow the online purchasing prompts.
- Home Delivery will be scheduled in January 2024. Orders placed by 14 December 2023 will be delivered before 25 January 2024.

## Booklist Frequently Asked Questions:

### What is Champion?

Champion is a third-party company who EDSC uses to administer our booklist and supply new books to students.

### Do I have to buy everything on the list?

You need to buy everything listed for the subjects your student is enrolled in. However, general stationery items such as pens and rulers do not need to be purchased from Champion if you already own these items or can source them elsewhere.

### Do I have to buy books through Champion, or can I buy second-hand books elsewhere?

You don't have to buy your student's books through Champion. However, there is a risk of buying incorrect editions of textbooks from other parties, as textbooks are revised regularly. If you'd like to buy second-hand books, we recommend buying them through the [Sustainable School Shop](#). This company has been supplied with the EDSC booklist and can help ensure you buy the correct editions.

### Why am I charged \$16.95 at the end of my order?

Champion charges a \$5.95 processing fee for all orders. Orders will also be charged an \$11 home delivery fee school delivery is not available. However, you may be able to organise order pick-up from Champion by contacting Champion directly.

### I am starting Year 7 in 2024, can I still order books without an EDSC email address?

New students who have not been given their EDSC email address yet can use a personal email for Champion orders. The book order and digital bundle will be matched to your EDSC email when it is created.

For further assistance, please contact: **Campion Education (Australia) Pty Ltd** – 1300 433 982

Alternatively, you may be able to go directly to the Champion store:

1/170-180 Rooks Road

Nunawading, Victoria, 3131

Phone: 1300 433 982

### Do we have to bring all the books in on the first day of school?

No, you can stagger what you bring in to make it easier. For the first few days students will only require their device, pencil case and something to write on.

# PADLOCKS

---

All students are required to secure their locker with a suitable strong padlock, it is important for students to have secure locks to ensure any personal belongings, including school work and laptops, are protected. This is a requirement of the students 1 to 1 Digital Learning Agreement. This can be either a combination or keyed lock. Please ensure that the student has one for the first day of school. If the lock is key mechanism, please bring the spare key to the Middle School Office for those occasions when keys cannot be found.

# COMPASS

---

East Doncaster Secondary College uses a community portal called 'Compass'. This is the primary means of communication between the school and home. Parents are able to login to Compass via this link <https://edsc-vic.compass.education> or via the school website.

## **Compass log in details will be sent to parents/guardians during Term 4 2023.**

Each family listed in the school administration database has a unique login for Compass. To access your child's personal information click on the student profile link next to your child's photo.

- Reports – view your child's report as an electronic file. Please save a copy as a PDF for your records.
- Newsletter – the newsletter is published on Compass. Login to view it each fortnight.
- Teacher email – parents can email their child's teachers directly.
- Family Details – update your email address and phone numbers. The details listed are used to send emails and the SMS absences alerts.
- News Feed – provides information and reminders about events and activities. Your news feeds will only show information relevant to you and your children.
- Attendance - view your child's timetable/attendance online and approve absences.
- Parent/Student/Teacher interviews - book Parent/Student/Teacher interviews appointments with teachers online.
- School Photos – purchase school photos online.
- Payments/Consent - consent and pay for your child's excursion/incursion/camp/sporting events.

It is essential that parents/guardians log in regularly to access the Newsletter and check important information. It is also essential that the parent/guardian Username and Password is kept in a safe place, and not made available to students.

A parent guide to Compass can be found here: [CompassParentGuide.pdf](#)

# UNIFORM

## TERMS 1 & 4



Summer dress



**Ladies** tailored shorts navy blue



Flexiwaist formal shorts grey



Short sleeved shirt

## TERMS 2 & 3



Box pleat skirt



**Ladies** expandable tailored pant navy blue



Flexiwaist formal pants grey



Long sleeve shirt

## All year



Pullover Thomas Moore Blue Yrs 7-9



Pullover Navy Yrs 10-12



Soft shell jacket – **Must be worn over the pullover**

*Only for outside the classrooms*



Backpack with logo **compulsory**



Baseball cap

## Shoes



Girls: Only polishable black leather formal lace-up or T-Bar shoes. No platform soles or non-polishable shoes, no sport shoes including black leather sport shoes.

Boys: Only polishable black leather formal school shoes. No sport shoes including black leather sport shoes.

**Socks:**

Girls: Plain white colour, long or short. No logos or branding visible. No black socks. No tights in summer.

Boys: Grey only. No logos or branding visible. No black socks.

Hair accessories: If wearing hair ribbons – plain College blue or plain white.

Additional items for out of class:

Scarf – plain navy

Gloves – plain navy

## SPORT UNIFORM



*Sport top, Dunlop House*



*Sport top, Sutherland House*



*Sport top, Chisholm House*



*Sport top, Bradman House*



*Rugby jumper*



*Sport shorts*



*Tracksuit pants*

**Sport Uniform for Year 7, 8 and 9 only:** Year 7, 8 and 9 students only are allowed to wear the full official EDSC sports uniform on timetabled PE and Sport Education Day. This includes wearing this uniform to and from school. Variations of the sports uniform will not be accepted.

Sport shoes are to be worn with the sports uniform.

***All students are to wear the complete school uniform both at school, and on their way to and from school.***

Parents are able to purchase new uniforms at:

PSW - 12 Strathalbyn Street, East Kew

<https://www.psw.com.au>

## OFFICIAL EDSC SCHOOL BAGS

All students are required to have an East Doncaster Secondary College school bag. The official EDSC school bag is a compulsory part of the uniform. This is a requirement of the students 1 to 1 Digital Learning Agreement. This will ensure the students are prepared to start their first day of school with their full uniform, including the school bag. The official EDSC school bags may be purchased through our uniform provider PSW.

# 2024 - 1 TO 1 DIGITAL LEARNING PROGRAM

Information relating to East Doncaster Secondary College's 1 to 1 Digital Learning Program will be on a Compass Newsfeed.

## ACCEPTABLE USAGE AGREEMENT

### Acceptable usage agreement on Compass

Consent for the acceptable usage agreement is made via Compass when you complete your parent payments.

### Compass App

- ✓ Click the 'Payment Centre' Banner on your Home Page & select School Fees

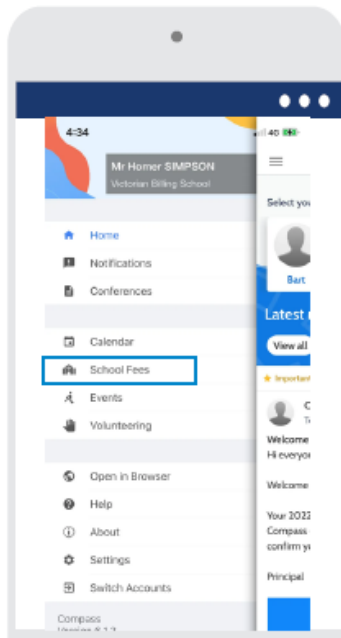

### Web Browser

- ✓ Select 'School Fees' from the 3 Bars / Side Menu

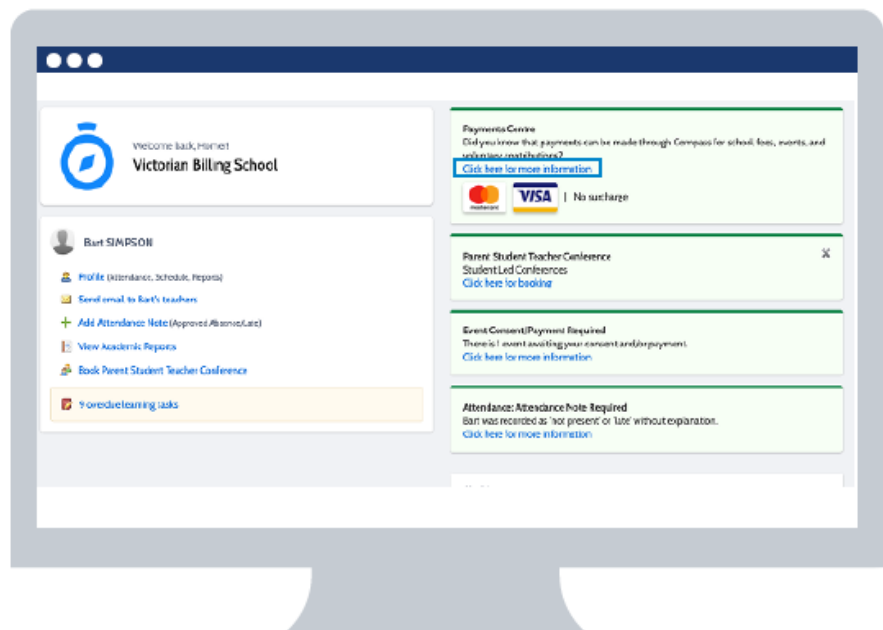

Click on "2024 Acceptable Usage Agreement". You will be required to work through a number of questions regarding your child and give consent by writing your full name in the Parent Agreement field.

# PARENT PAYMENTS

---

In order to provide the high-quality and successful academic and co-curricular programs within a comfortable learning environment for our students, the College relies on strong support from the College community.

Underlying this success are the parent contributions which supplement the Government's allocation to schools to provide materials and services. Such support enables us to enrich and extend the learning experiences of our students by offering enhanced curriculum and a wider range of subjects which meet the diverse needs of our 1800+ students.

This has enabled us to provide students with a purpose-built VCE Centre (The John Landy Centre), a high quality Performing Arts Centre, Sports Centre and Wellbeing Centre (The Phillip Gardner Centre). It also allows us to employ additional staff to support our students, improve our technology in the classroom and maintain the grounds and environment which makes us a school that excels.

**You will receive information regarding Parent Payments via Compass in Term 4 2023.**

For further information regarding our Parent Payments Policy, please see page 15 or the [College website](#)

Parent Payments are made up of three categories:

- **Curriculum Contributions**
- **Other Contributions**
- **Extra-Curriculum Items and Activities**

We seek your cooperation in the payment of these contributions via Compass or by Cash, EFTPOS or Credit Card on or before **Tuesday 12 December 2023**.

If you would like further information regarding Parent Payments, please contact Julie Lawrance, Accounts Receivable. We thank you in anticipation and look forward to an enjoyable and rewarding journey with your child and your family.

# PARENT PAYMENTS POLICY

## PARENT PAYMENTS POLICY

### ONE PAGE OVERVIEW



#### FREE INSTRUCTION

- Schools provide students with free instruction and ensure students have free access to all items, activities and services that are used by the school to fulfil the requirements of the Curriculum. This includes the Victorian Curriculum F-10, the Victorian Certificate of Education (VCE) including the VCE Vocational Major and the Victorian Pathways Certificate.
- Schools may invite parents to make a financial contribution to support the school.



#### PARENT PAYMENT REQUESTS

Schools can request contributions from parents under three categories:

##### Curriculum Contributions

Voluntary financial contributions for curriculum items and activities which the school deems necessary for students to learn the Curriculum.

##### Other Contributions

Voluntary financial contributions for non-curriculum items and activities that relate to the school's functions and objectives.

##### Extra-Curricular Items and Activities

Items and activities that enhance or broaden the schooling experience of students and are above and beyond what the school provides for free to deliver the Curriculum. These are provided on a user-pays basis.

- Schools may also invite parents to supply or purchase educational items to use and own (e.g. textbooks, stationery, digital devices).



#### FINANCIAL HELP FOR FAMILIES

- Schools put in place financial hardship arrangements to support families who cannot pay for items or activities so that their child doesn't miss out.
- Schools have a nominated parent payment contact person(s) that parents can have a confidential discussion with regarding financial hardship arrangements.



#### SCHOOL PROCESSES

- Schools must obtain school council approval for their parent payment arrangements and publish all requests and communications for each year level on their school website for transparency.

For a more detailed policy – please head to <https://www2.education.vic.gov.au/pal/parent-payment/policy>



# EVACUATION

## SAFETY OF STUDENTS & STAFF IS PARAMOUNT

### Recommended Steps for Evacuation (Detailed)

<b>ANNOUNCEMENT:</b>	Generally there will be a <b>loudspeaker message</b> . A few emergency pips will sound to get your attention and a message will be given, followed by prolonged emergency pips.  If the PA is not working a <b>messenger will come to your room</b> .
<b>PROCEDURE:</b>	<b>Students are to assemble</b> ready to evacuate and <b>await instructions</b> .
	<b>Teachers are to make sure doors and windows are closed</b> .
	<b>Leave all books and belongings</b> in the classroom and exit through nearest external door if possible, <b>closing classroom door behind you</b> .
	<b>Move as a class in an orderly manner</b> , without running, to the evacuation assembly area (usually on the covered basketball courts or School Oval).
	<b>Keep away from buildings</b> and <b>do not go to lockers or toilets</b> .
	The <b>route to the assembly area will be at the discretion of the class teacher</b> , avoiding congested areas where possible. <b>Move away from the danger zone at all times</b> . If the shortest route moves you close to the danger zone, you will be directed via a different route.

In the event of less than a complete evacuation, all other staff and students will stay in their classroom until further notice.

<b>AT THE ASSEMBLY AREA:</b>	The evacuation assembly area will be on the <b>covered Basketball courts &amp; Tennis Courts</b> on the south side of the school buildings near the oval.  <b>Do not use the passage between 300 Block and the Canteen. Do not use the passage between the Canteen and The John Landy Centre (JLC)</b>
	<b>Years 7 to 10 Home Groups</b> will assemble on the covered Basketball courts in home group order from 7A on the western side (closest to Westfield Doncaster) on the North court (closest to the school buildings).  <b>Years 11 &amp; 12 Home Groups</b> will assemble on the Tennis Courts in home group order from 11A on the western side (closest to Westfield Doncaster) on the Southern court (further from the school buildings).
	Students will stand in straight lines in <b>ALPHABETICAL SURNAME ORDER</b> until the roll has been marked by a teacher and will then be asked to sit until all students are accounted for.

### Recommended Steps for College Lock Down

<b>ANNOUNCEMENT:</b>	In an emergency where it is appropriate for students and staff to remain isolated from danger, a <b>SCHOOL LOCKDOWN</b> will be called over the public address system or by messenger to classrooms.
<b>PROCEDURE:</b>	Classroom teachers will direct students to <b>sit on the floor of the classroom, below window height</b> .
	Staff and students are to remain in this position until informed that it is safe to resume activities or that they are to evacuate to another site.



# COLLEGE MAP

GEORGE STREET

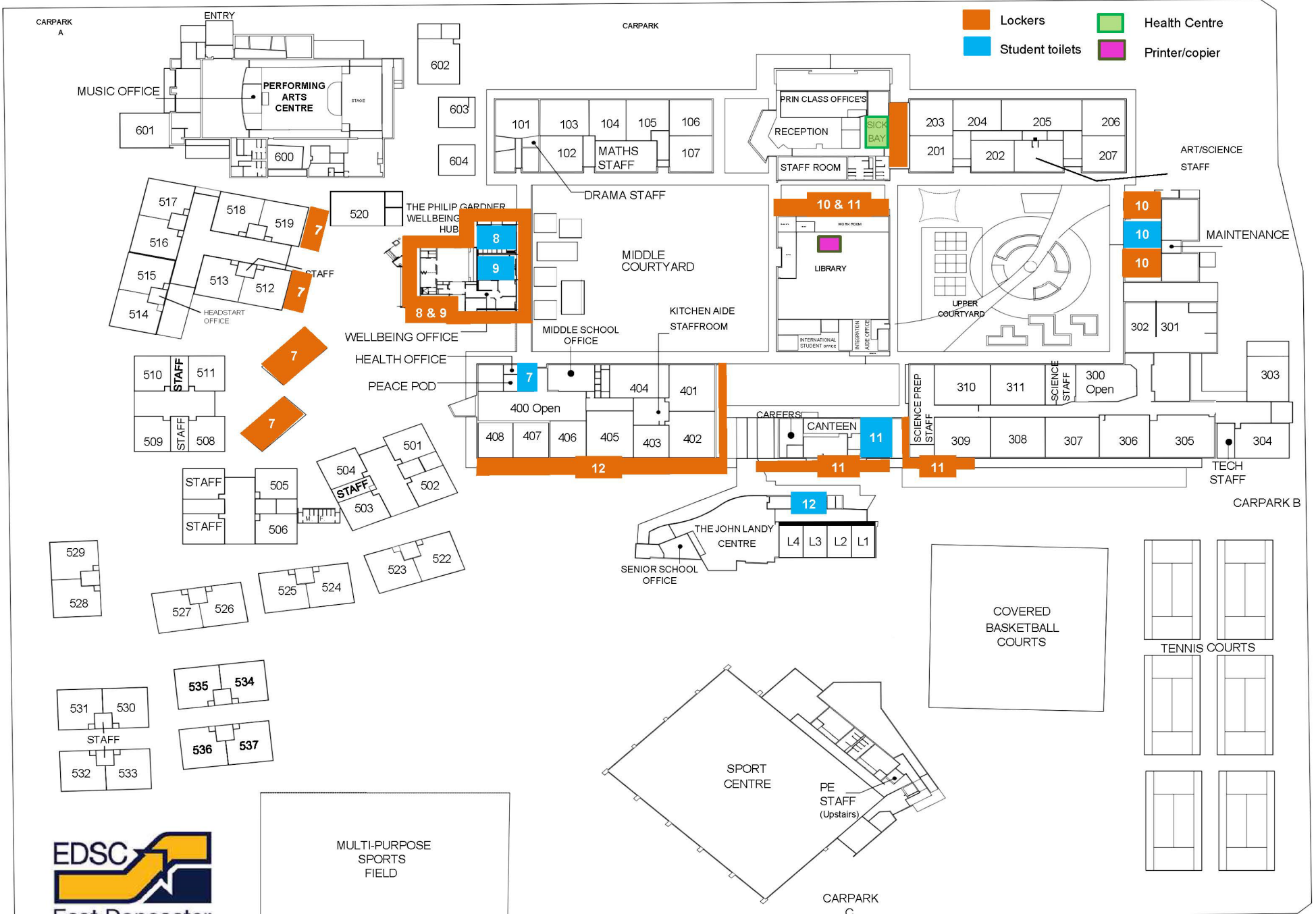

DRYDEN STREET

DRYDEN STREET



## VALUES

'These values underpin the culture of our school community as we embrace the challenges of 21st Century schooling.'

*Creating a Culture of Curiosity*

**East Doncaster**  
Secondary College

### CURIOSITY

- love of learning
- trying new things
- developing an awareness of our global community
- developing a sense of interest and wonder

### EXCELLENCE

- the development of self discipline and pursuit of improvement in academic results, sport, the arts and personal development
- always doing your best and supporting and celebrating others to do the same
- the continuous improvement in the teaching and learning program

### FAIRNESS

- providing opportunities for everyone to participate
- consistency of approach
- respect for individual differences

### RESPECT

- rights of all members of the community to achieve their full potential
- care of the physical environment and the property of others
- acceptance of individual differences and the cultural diversity within the school community
- self respect

### RESILIENCE

- persistence
- courage to give and accept advice for improvement
- positively adapting to change
- trying again to get it right

### TEAMWORK

- the encouragement of collaboration and cooperation
- support given to all members of the college community
- contributing to a safe, secure environment
- strong partnerships between parents, teachers and students
- working together in a positive and constructive way.

### CARE AND COMPASSION

- concern for the welfare of others
- playing a positive role in your school community
- being sensitive and understanding to the needs of others

